



# R-31 CB



The R-31 CB was the first Ranger Tug to feature a command bridge. It is equipped with electronic controls at both the upper and lower helm stations and the redesigned bridge has a table and room to seat six. The command bridge also retracts to allow for trailering. She comes standard with bow and stern thrusters for ease of handling. The foredeck features seating and a table that can be raised for entertaining and lowered while underway. The generous cockpit also features wraparound seating utilizing hidden seats that fold out of the gunwale. The interior layout of the R-31 CB features two staterooms - one large island berth forward with en suite head and a midship berth with day head. A starboard side door provides easy access from the lower helm to the side decks for line handling. Like all Ranger Tugs, the R-31 CB comes essentially turn-key with standard features and equipment intended to make her owner's experience hassle-free and allow for ease of handling and comfort under way.

## Specifications

Length (molded)	31' 2"	9.5 m
Length (w/swim step)	35' 2"	10.72 m
Beam	10'	3.05 m
Draft	28"	.71 m
Bridge clearance (bridge/mast up)	17' 9"	5.41 m
Bridge clearance (bridge/mast down)	10' 3"	3.12 m
Height on trailer (bridge/mast down)	13' 4"	4.06 m
Length on trailer	41' 8"	12.70 m
Fuel capacity	180 US Gal	681.37 L
Water capacity	80 US Gal	302.83 L
Hot water	11 US Gal	41.64 L
Holding tank capacity	40 US Gal	151.42 L
Weight, Dry	11,500 lbs	5,216.31 kg
Engine	Volvo D4 300 HP diesel common rail electronic engine	

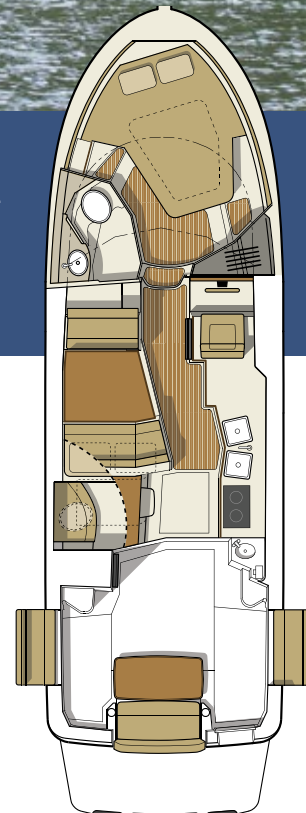



# Ranger Tugs R-31 CB Value Package Pricing

All Ranger 31 models are sold **fully equipped** and **ready-to-cruise**. There are two packages to choose from, the Luxury Edition with a diesel generator and air conditioning or the Northwest Edition with a diesel forced air furnace and downrigger plugs and pads.

## Northwest Edition Included Features:

- AIS 300
- Anchor Package 22# anchor, 50' HT chain, 200' line
- AGM batteries
- Autopilot, dual station, Garmin w/ remote
- **Diesel heater, forced air furnace**
- **Downrigger plugs & pads**
- LED lights
- Macerator discharge
- Navigation package, Garmin 7612 upper/7616 lower, 4kw HD radar dome, GPS ant., depth/ff
- Swim platform rails
- Safety kit
- Solar panel, 145 watt w/control panel
- Thruster wireless remote
- Underwater lights

**FULLY EQUIPPED, READY-TO-CRUISE FROM:**

**\$309,937.00\***

## Luxury Edition Included Features:

- AIS 300
- **Air conditioning/ rev cycle heat**
- Anchor Package 22# anchor, 50' HT chain, 200' line
- AGM batteries
- Autopilot, dual station, Garmin w/ remote
- **Generator, diesel w/sound shield**
- LED lights
- Macerator discharge
- Navigation package, Garmin 7612 upper/7616 lower, 4kw HD radar dome, GPS ant., depth/ff
- Swim platform rails
- Safety kit
- Solar panel, 145 watt w/control panel
- Thruster wireless remote
- Underwater lights

**FULLY EQUIPPED, READY-TO-CRUISE FROM:**

**\$324,937.00\***

## Standard Features

### Performance

Volvo 300 HP D4 common rail diesel engine  
Bow and stern thrusters  
Full color electronic engine control display  
Single lever, electronic shift and throttle control  
Trim tabs



### Boater Features

Anchor locker, S.S. self-launching bow roller through stem  
Electrical panels AC/DC  
Command bridge, retractable, compass, second station VHF, electronic controls, thruster control, trim tab control  
Command bridge, seating for six, table for entertaining  
Folding S.S. mast for trailering  
Fuel flow data display  
Pilot house door, stbd side, sliding, locking  
Powered engine hatch  
Rod holders  
Sea water strainers  
Sport racks  
Swim step w/built-in fenders and swim ladder  
Wash down system, raw water  
Windlass with bow and helm controls



### Convenience

Cabin Heater (engine)  
Cockpit convenience center, sink  
Cockpit table and seating  
Cowl vent (ventilation in forward cabin)

Dinette, salon, converts to bed, high/low table, sleeps 2  
Double wide, reversible companion seat  
Enclosed head, vessel sink, shower with enclosure  
Foredeck seat and table  
Forward deck hatch, opening translucent  
Hatches (5), pilothouse roof, opening with screens  
Holding tank level monitor  
Inverter, 2000w, PSW  
Island bed, master stateroom (memory foam)  
Lounge seating, dinette converts to lounge for reading  
Marine heads (2), fore and aft, electric, holding tank, pump out  
Midship stateroom, double berth, privacy door, day head  
Outlets 110V (5)  
Microwave  
Portlights, brass, opening with hooks  
Power outlets, 12V port and stbd, master state room, midship  
Refrigerator/freezer, galley, 12V  
Refrigerator/freezer, cockpit, 12V  
Sinks (4), fresh water system w/demand pump, H and C  
Storage lockers (6), cabin, w/teak louvered doors  
Stove/oven, propane, two burner, includes propane box, (2) tanks  
Transom door for easy boarding  
Visor/drip rails, fwd and side windows  
Water tank level monitor (fresh)  
Windshield wipers (4) pantographic  
Wine cooler - water, 12V, (6) bottle

### Safety

Diesel power  
Co Monitors (2), 12V  
Courtesy lights, cockpit entry steps, swim step, and walkways



Dual trumpet electric horn  
Illuminated compasses (2)  
Navigation lights, with light boards  
Spotlight w/remote control  
VHF radio (dual station), Garmin with ant., DSC capable  
Window defrosters

### Entertainment

Entertainment center, master stateroom with 22" TV/DVD  
Entertainment center, salon with 19" overhead TV/DVD  
Fusion stereo system, (8) speakers, Bluetooth (controllable through Garmin GPS)

### Construction

Bonded electrical system  
Bronze rudder, propeller, and thru-hulls  
Fiberglass cockpit liner, self-bailing w/non-skid  
Fiberglass stringer  
S.S. cleats, rails, ext. hardware  
Sunbrella fabrics  
Teak and Holly cabin sole  
Vinylester barrier coat (hull)



## Additional Factory Options

Aft steering, second station with electronic controls	\$4,970
Aluminum triple axle trailer, electric/hydraulic brakes, spare tire w/bracket	\$15,600
Carpet runner, Teak and Holly, cockpit	\$720
Carpet runner, Teak and Holly, interior	\$620
Cockpit ice maker (in lieu of cockpit refrigerator)	\$470
Dinghy, inflatable RIB 290 CSM hypalon with Weaver davits, stand-off & winch	\$5,125
Dinghy motor, Yamaha F2.5, 4-stroke, storage bracket	\$1,115
Dinghy motor, Yamaha F6, 4-stroke, storage bracket	\$1,945
Dinghy motor, Yamaha F9.9, 4-stroke, storage bracket	\$2,935
Factory Delivery Experience	\$2,500
Garmin GXM 52 XM/weather antenna	\$870
International option, 240v	\$900
Low speed module	\$2,000

\*Options, freight & taxes extra

Prices, specifications, equipment and options may change without notice. 816



MADE IN USA



25802 Pacific Highway South

Kent, WA 98032

Phone 253-839-5213

[www.RangerTugs.com](http://www.RangerTugs.com)

