



R-31 S



The R-31 S is the largest in the Ranger Tugs fleet making her ideal for extended cruising while remaining a trailerable trawler. She comes standard with bow and stern thrusters for ease of handling. The foredeck features seating and a table that can be raised for entertaining and lowered while underway. The generous cockpit also features wraparound seating utilizing hidden seats that fold out of the gunwale. The interior layout of the R-31 S features two staterooms - one large island berth forward with en suite head and a midship berth with day head. A starboard side door provides easy access from the helm to the side decks for line handling. Like all Ranger Tugs, the R-31 S comes essentially turn-key with standard features and equipment intended to make her owner's experience hassle-free and allow for ease of handling and comfort under way.

Specifications

| | | |
|------------------------------|--|-------------|
| Length (molded) | 31' 2" | 9.5 m |
| Length (w/swim step) | 35' 2" | 10.72 m |
| Beam | 10' | 3.05 m |
| Draft | 28' | .71 m |
| Bridge clearance (mast up) | 14' 0" | 4.27 m |
| Bridge clearance (mast down) | 9' 8" | 2.95 m |
| Height on trailer | 13' 1" | 3.99 m |
| Length on trailer | 41' 8" | 12.70 m |
| Fuel capacity | 180 US Gal | 681.37 L |
| Water capacity | 80 US Gal | 302.83 L |
| Hot water | 11 US Gal | 41.64 L |
| Holding tank capacity | 40 US Gal | 151.42 L |
| Weight, Dry | 11,000 lbs | 4,989.52 kg |
| Engine | Volvo D4 300 HP diesel common rail electronic engine | |

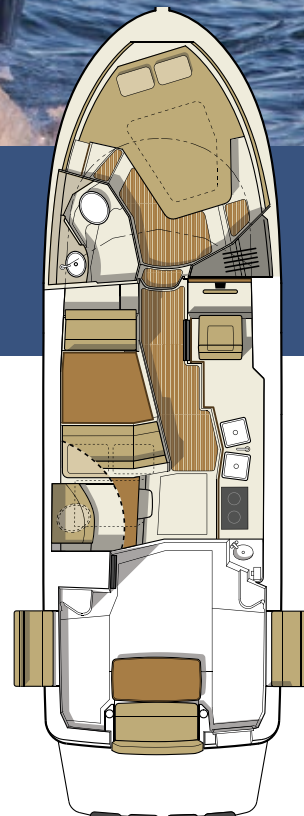

Ranger Tugs R-31 S Value Package Pricing

All Ranger 31 models are sold **fully equipped** and **ready-to-cruise**. There are two packages to choose from, the Luxury Edition with a diesel generator and air conditioning or the Northwest Edition with a diesel forced air furnace and downrigger plugs and pads.

Northwest Edition Included Features:

- AIS 300
- Anchor Package 22# anchor, 50' HT chain, 200' line
- AGM batteries
- Autopilot, dual station, Garmin w/ remote
- **Diesel heater, forced air furnace**
- **Downrigger plugs & pads**
- LED lights
- Macerator discharge
- Navigation package, Garmin 7616, 4kw HD radar dome, GPS ant., depth/ff
- Swim platform rails
- Safety kit
- Solar panel, 145 watt w/control panel
- Thruster wireless remote
- Underwater lights

FULLY EQUIPPED, READY-TO-CRUISE FROM:

\$289,937.00*

Luxury Edition Included Features:

- AIS 300
- **Air conditioning/ rev cycle heat**
- Anchor Package 22# anchor, 50' HT chain, 200' line
- AGM batteries
- Autopilot, dual station, Garmin w/ remote
- **Generator, diesel w/sound shield**
- LED lights
- Macerator discharge
- Navigation package, Garmin 7616, 4kw HD radar dome, GPS ant., depth/ff
- Swim platform rails
- Safety kit
- Solar panel, 145 watt w/control panel
- Thruster wireless remote
- Underwater lights

FULLY EQUIPPED, READY-TO-CRUISE FROM:

\$304,937.00*

Standard Features

Performance

Volvo 300 HP D4 common rail diesel engine
Bow and stern thrusters
Full color electronic engine control display
Single lever, electronic shift and throttle control
Trim tabs

Boater Features

Anchor locker, S.S. self-launching bow roller through stem
Electrical panels AC/DC
Folding S.S. mast for trailering
Fuel flow data display
Pilothouse door, stbd side, sliding, locking
Powered engine hatch
Rod holders
Sea water strainers
Sport racks
Swim step w/ built-in fenders and swim ladder
Wash down system, raw water
Windlass with bow and helm controls

Convenience

Cabin Heater (engine)
Cockpit convenience center, sink
Cockpit table and seating
Cowl vent (forward cabin ventilation)
Dinette, salon, converts to bed, high/low table, sleeps 2
Double wide, reversible companion seat



Enclosed head, vessel sink, shower with enclosure
Foredeck seat and table
Forward deck hatch, opening translucent
Hatches (5), pilothouse roof, opening with screens
Holding tank level monitor
Inverter, 2000w, PSW
Island bed, master stateroom (memory foam)
Lounge seating, dinette converts to lounge for reading
Marine heads (2), fore and aft, electric, holding tank, deck pump out
Midship stateroom, double berth, privacy door, head
Outlets 110V (5)
Microwave
Portlights, brass, opening with hooks
Power outlets, 12V port and stbd, master state room, midship
Refrigerator/freezer, galley, 12V
Refrigerator/freezer, cockpit, 12V
Sinks (4), fresh water system w/demand pump, H and C
Storage lockers (6), cabin, w/teak louvered doors
Stove/oven, propane, two burner, includes propane box, (2) tanks
Transom door for easy boarding
Visor/drip rails, fwd and side windows
Water tank level monitor (fresh)
Windshield wipers (4) pantographic
Wine/water cooler, 12V, (6) bottle

Safety

Diesel power
Co Monitors (2), 12V
Courtesy lights, cockpit entry steps, swim step, and walkways

Dual trumpet electric horn
Illuminated compass
Navigation lights, with light boards
Spotlight w/remote control
VHF radio, Garmin with antenna, DSC capable
Window defrosters

Entertainment

Entertainment center, master stateroom with 22" TV/DVD
Entertainment center, salon with 19" overhead TV/DVD
Fusion stereo, (6) speakers, Bluetooth (controllable through Garmin GPS)

Construction

Bonded electrical system
Bronze rudder, propeller, and thru-hulls
Fiberglass cockpit liner, self-bailing w/non-skid
Fiberglass stringer
S.S. cleats, rails, ext. hardware
Sunbrella fabrics
Teak and Holly cabin sole
Vinylester barrier coat (hull)



Additional Factory Options

| | |
|---|----------|
| Aft steering, second station with electronic controls | \$4,970 |
| Aluminum triple axle trailer, electric/hydraulic brakes, spare tire w/bracket | \$15,600 |
| Carpet runner, Teak and Holly, cockpit | \$720 |
| Carpet runner, Teak and Holly, interior | \$620 |
| Cockpit ice maker (in lieu of cockpit refrigerator) | \$470 |
| Dinghy, inflatable RIB 290 CSM hypalon with Weaver davits, stand-off & winch | \$5,125 |
| Dinghy motor, Yamaha F2.5, 4-stroke, storage bracket | \$1,115 |
| Dinghy motor, Yamaha F6, 4-stroke, storage bracket | \$1,945 |
| Dinghy motor, Yamaha F9.9, 4-stroke, storage bracket | \$2,935 |
| Factory Delivery Experience | \$2,500 |
| Garmin GXM 52 XM/weather antenna | \$870 |
| International option, 240v | \$900 |
| Low speed module | \$2,000 |

*Options, freight & taxes extra

Prices, specifications, equipment and options may change without notice. 816



MADE IN USA



25802 Pacific Highway South

Kent, WA 98032

Phone 253-839-5213

www.RangerTugs.com

